

Licensing Act 2003
Premises Licence

LEIPRM1772



Leicester
City Council

Local Services & Enforcement
 Leicester City Council
 York House
 91 Granby Street
 Leicester
 LE1 6FB

(0116) 4543040
licensing@leicester.gov.uk

Part 1 - Premises Details

POSTAL ADDRESS OF PREMISES, OR IF NONE, ORDNANCE SURVEY MAP REFERENCE OR DESCRIPTION

Shisha Cafe

161 Belgrave Gate, Leicester, LE1 3HS.

WHERE THE LICENCE IS TIME LIMITED THE DATES

Not applicable

Expires **no expiry**

LICENSABLE ACTIVITIES AUTHORISED BY THE LICENCE

- a performance of a play
- an indoor sporting event
- any playing of recorded music
- entertainment of a similar description to that falling within a performance of live music, any playing of recorded music or a performance of dance
- provision of late night refreshment
- the supply of alcohol

THE TIMES THE LICENCE AUTHORIZES THE CARRYING OUT OF LICENSABLE ACTIVITIES

Activity (and Area if applicable)	Description	Time From	Time To
A. Performance of a play (Indoors & Outdoors)	Monday to Sunday		
C. Indoor sporting event	Monday to Sunday		
F. Playing of recorded music (Indoors & Outdoors)	Sun-Thur Fri-Sat	10:00am 10:00am	12:30am 1:00am
H. Entertainment of a similar description to that falling within E, F, or G (Indoors & Outdoors)	Monday to Sunday		
I. Late night refreshment (Indoors & Outdoors)	Monday to Sunday	11:00pm	2:00am
J. Supply of alcohol for consumption ON and OFF the premises	Monday to Sunday	10:00am	1:00am

THE OPENING HOURS OF THE PREMISES

Description	Time From	Time To
Monday to Sunday	10:00am	2:00am



Licensing Act 2003

Premises Licence

LEIPRM1772



Leicester
City Council

Local Services & Enforcement
Leicester City Council
York House
91 Granby Street
Leicester
LE1 6FB

(0116) 4543040
licensing@leicester.gov.uk

WHERE THE LICENCE AUTHORISES SUPPLIES OF ALCOHOL WHETHER THESE ARE ON AND / OR OFF SUPPLIES

- J. Supply of alcohol for consumption ON and OFF the premises

Part 2

NAME, (REGISTERED) ADDRESS, TELEPHONE NUMBER AND EMAIL (WHERE RELEVANT) OF HOLDER OF PREMISES LICENCE

Mohammad Salih Attuf

2 Avington Close, Leicester, LE3 9ET.

REGISTERED NUMBER OF HOLDER, FOR EXAMPLE COMPANY NUMBER, CHARITY NUMBER (WHERE APPLICABLE)

NAME, ADDRESS AND TELEPHONE NUMBER OF DESIGNATED PREMISES SUPERVISOR WHERE THE PREMISES LICENCE AUTHORISES THE SUPPLY OF ALCOHOL

Mohammad Salih ATTUF

PERSONAL LICENCE NUMBER AND ISSUING AUTHORITY OF PERSONAL LICENCE HELD BY DESIGNATED PREMISES SUPERVISOR WHERE THE PREMISES LICENCE AUTHORISES FOR THE SUPPLY OF ALCOHOL

Licence No. LEIPRS2248

Issued by Leicester



Licensing Act 2003
Premises Licence

LEIPRM1772



Leicester
City Council

Local Services & Enforcement
Leicester City Council
York House
91 Granby Street
Leicester
LE1 6FB

(0116) 4543040
licensing@leicester.gov.uk

ANNEXES

Annex 1 - Mandatory conditions

No supply of alcohol may be made under the premises licence -

- a) at a time when there is no designated premises supervisor in respect of the premises licence, or
- b) at a time when the designated premises supervisor does not hold a personal licence or his personal licence is suspended.

Every supply of alcohol under the premises licence must be made or authorised by a person who holds a personal licence.

The responsible person must ensure that staff on relevant premises do not carry out, arrange or participate in any irresponsible promotions in relation to the premises. In this paragraph, an irresponsible promotion means any one or more of the following activities, or substantially similar activities, carried on for the purpose of encouraging the sale or supply of alcohol for consumption on the premises-

- a) games or other activities which require or encourage, or are designed to require or encourage, individuals to-
 - i) drink a quantity of alcohol within a time limit (other than to drink alcohol sold or supplied on the premises before the cessation of the period in which the responsible person is authorised to sell or supplied alcohol), or
 - ii) drink as much alcohol as possible (whether within a time limit or otherwise);
- b) provision of unlimited or unspecified quantities of alcohol free or for a fixed or otherwise fee to the public or to a group defined by a particular characteristic in a manner which carries a significant risk of undermining a licensing objective;
- c) provision of free or discounted alcohol or any other thing as a prize to encourage or reward the purchase and consumption of alcohol over a period of 24 hours or less in a manner which carries a significant risk of undermining a licensing objective;
- d) selling or supplying alcohol in association with promotional posters or flyers on, or in the vicinity of, the premises which can reasonably be considered to condone, encourage or glamorise anti-social behaviour or to refer to the effects of drunkenness in any favourable manner;
- e) dispensing alcohol directly by one person into the mouth of another (other than where that other person is unable to drink without assistance by reason of a disability).

The responsible person must ensure that free potable water is provided on request to customers where it is reasonably available.

The premises licence holder or club premises certificate holder must ensure that an age verification policy is adopted in respect of the premises in relation to the sale or supply of alcohol.

The designated premises supervisor in relation to the premises licence must ensure that the supply of alcohol at the premises is carried on in accordance with the age verification policy.

The policy must require individuals who appear to the responsible person to be under 18 years of age (or such older age as may be specified in the policy) to produce on request, before being served alcohol, identification bearing their photograph, date of birth and either-

- a) a holographic mark, or
- b) an ultraviolet feature.

The responsible person shall ensure that-

- a) where any of the following alcoholic drinks is sold or supplied for consumption on the premises (other than alcoholic drinks sold or supplied having been made up in advance ready for sale or supply in a securely closed container) it is available to customers in the following measures-
 - i) beer or cider: ½ pint;
 - ii) gin, rum, vodka or whisky: 25 ml or 35 ml; and
 - iii) still wine in a glass: 125 ml;
- b) these measures are displayed in a menu, price list or other printed material which is available to customers on the premises; and
- c) where a customer does not in relation to a sale of alcohol specify the quantity of alcohol to be sold, the customer is made aware that these measures are available.

A relevant person shall ensure that no alcohol is sold or supplied for consumption on or off the premises for a price which is less than the permitted price.

All individual(s) at the premises for the purpose of carrying out a security activity must

- (a) be authorised to carry out that activity by a licence granted under the Private Security Industry Act 2001; or
- (b) be entitled to carry out that activity by virtue of section 4 of that Act.

Annex 2 - Conditions consistent with the operating schedule

Staff will receive training on the Licensing Act and the licensing objectives





Leicester
City Council

Local Services & Enforcement
Leicester City Council
York House
91 Granby Street
Leicester
LE1 6FB

(0116) 4543040
licensing@leicester.gov.uk

ANNEXES continued ...

A personal licence holder fluent in English will be on the premises at all times when alcohol is permitted to be sold
Food and soft drinks will be available at all times in all areas of the premises where intoxicants are provided.
CCTV will cover internal and external areas of the premises and recordings will be kept for 31 days
No beers, lagers, ciders or spirit mixtures above 5.5% ABV will be sold at the premises apart from premium beers and ciders supplied in glass bottles.
An incident log shall be kept at the premises and available for inspection by the responsible authorities.
Notices will be displayed at all exits asking customers to leave the quietly

Annex 3 - Conditions attached after a hearing by the Licensing Authority

All staff will be trained on use of the CCTV system
CCTV footage will be provided to the relevant authorities within 24 hours of a request being made
SIA door staff will be employed after 23:00 when alcohol is being served. There will be one SIA trained door staff for the first 100 customers then an additional one after that. They will remain on site until the venue is closed. A log will be kept on site to record door staff details and the dates they were employed.
Promote 'Ask Angela' campaign (or similar). Ensuring all staff are given sufficient training every six months and a training log is kept and made available for the relevant authorities.
Training will be provided for all members of staff in relation to age verification (Challenge 25), the responsible sale of alcohol and the 4 licensing objectives. This training is to be documented and signed for by each staff and those records made available to the police and responsible authorities on request. This training should be refreshed every six months.



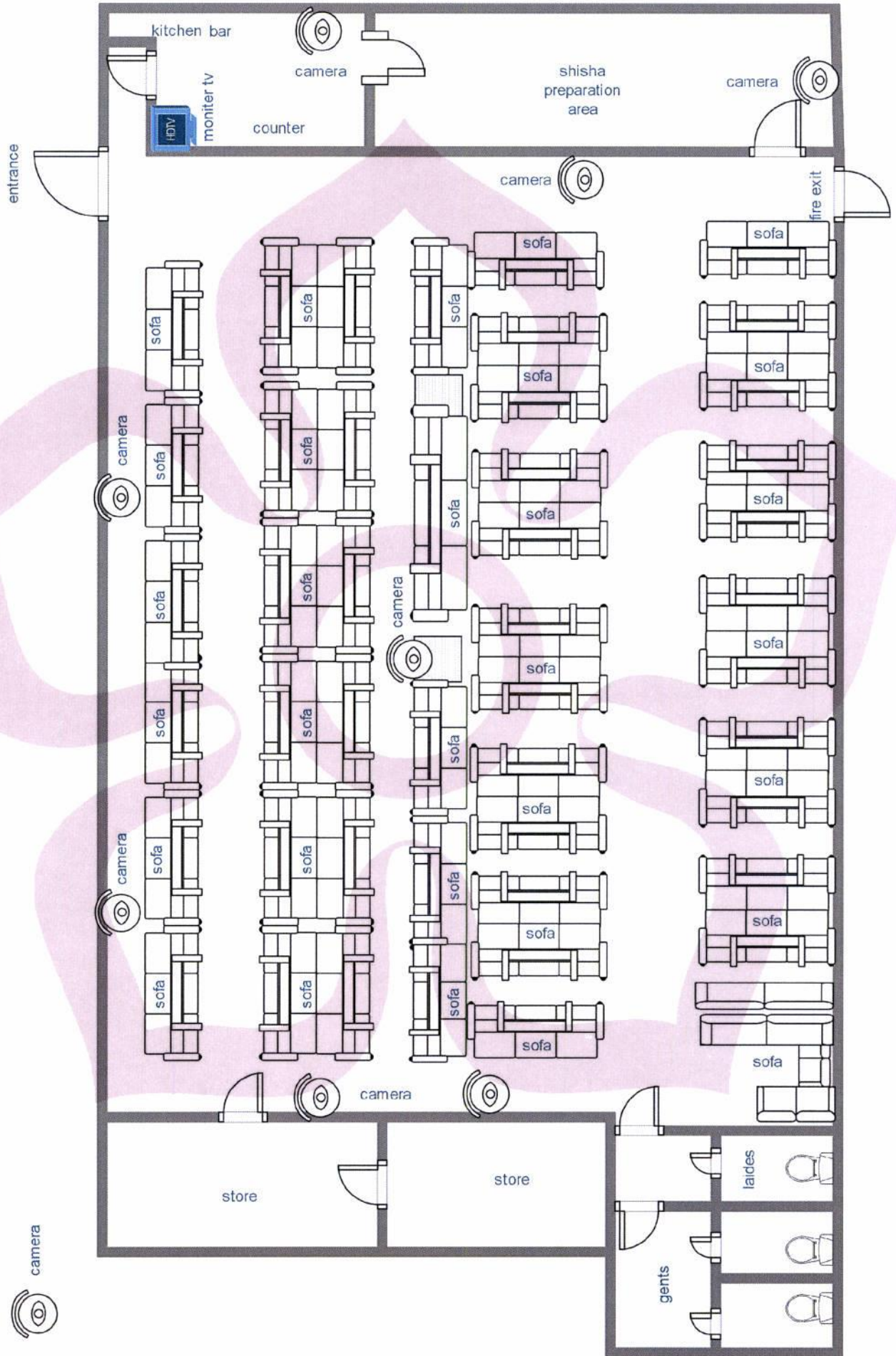



Leicester
City Council

Local Services & Enforcement
Leicester City Council
York House
91 Granby Street
Leicester
LE1 6FB

(0116) 4543040
licensing@leicester.gov.uk

Premises Details

POSTAL ADDRESS OF PREMISES, OR IF NONE, ORDNANCE SURVEY MAP REFERENCE OR DESCRIPTION

Shisha Cafe

161 Belgrave Gate, Leicester, LE1 3HS.

WHERE THE LICENCE IS TIME LIMITED THE DATES

Not applicable

LICENSABLE ACTIVITIES AUTHORISED BY THE LICENCE

- a performance of a play
- an indoor sporting event
- any playing of recorded music
- entertainment of a similar description to that falling within a performance of live music, any playing of recorded music or a performance of dance
- provision of late night refreshment
- the supply of alcohol

THE TIMES THE LICENCE AUTHORISES THE CARRYING OUT OF LICENSABLE ACTIVITIES

Activity (and Area if applicable)	Description	Time From	Time To
A. Performance of a play (Indoors & Outdoors)	Monday to Sunday		
C. Indoor sporting event	Monday to Sunday		
F. Playing of recorded music (Indoors & Outdoors)	Sun-Thur	10:00am	12:30am
	Fri-Sat	10:00am	1:00am
H. Entertainment of a similar description to that falling within E, F, or G (Indoors & Outdoors)	Monday to Sunday		
I. Late night refreshment (Indoors & Outdoors)	Monday to Sunday	11:00pm	2:00am
J. Supply of alcohol for consumption ON and OFF the premises	Monday to Sunday	10:00am	1:00am

THE OPENING HOURS OF THE PREMISES

Description	Time From	Time To
Monday to Sunday	10:00am	2:00am



Licensing Act 2003

Premises Licence Summary

LEIPRM1772



Leicester
City Council

Local Services & Enforcement
Leicester City Council
York House
91 Granby Street
Leicester
LE1 6FB

(0116) 4543040
licensing@leicester.gov.uk

WHERE THE LICENCE AUTHORISES SUPPLIES OF ALCOHOL WHETHER THESE ARE ON AND / OR OFF SUPPLIES

- J. Supply of alcohol for consumption ON and OFF the premises

NAME, (REGISTERED) ADDRESS OF HOLDER OF PREMISES LICENCE

Mohammad Salih Attuf

2 Avington Close, Leicester, LE3 9ET.

REGISTERED NUMBER OF HOLDER, FOR EXAMPLE COMPANY NUMBER, CHARITY NUMBER (WHERE APPLICABLE)

NAME OF DESIGNATED PREMISES SUPERVISOR WHERE THE PREMISES LICENCE AUTHORISES THE SUPPLY OF ALCOHOL

Mohammad Salih ATTUF

STATE WHETHER ACCESS TO THE PREMISES BY CHILDREN IS RESTRICTED OR PROHIBITED

Not applicable

